



CAMPING - VILLAGE PARCO DELLE PISCINE



53047 SARTEANO (SIENA)
Tel. +39-0578-26971 Fax +39-0578-265889
info@parcodellepiscine.it
www.parcodellepiscine.it



Certified Environmental
Management
Reg. N. I – 000275

RULES AND PRICE LIST OF THE CAMPSITE- 2015

BOOKING PITCHES AND MOBILE HOMES

Directly through our **web site** (www.parcodellepiscine.it), or by checking availability with our reservations office by means of **fax, phone** or **e-mail**. After determining availability, booking must be made by following the instructions on the “Booking form and deposit payment” (page 5) with a deposit of:

- € 200.00 for **pitch** booking
- € 400.00 for **mobile home** booking.

You will receive confirmation of your booking only after the deposit has been received.

RECEPTION: VIA CAMPO DEI FIORI 30

Check-in **from 8 a.m. to 1 p.m.** and **from 4 p.m. to 11 p.m.**

Minors must be accompanied by an adult.

Reception procedures are as follows:

- registration of an identification document
- an adhesive label will be stuck to the windscreen of the car, allowing free access
- a copy of the “Rules and price list” and a hand-book on the “environmental policy” will be provided.

Mobile homes are available to our guests **from 4 p.m.** the day of arrival.

ANIMALS PROHIBITED

OPENING TIMES

The main **entrance gate**, at Reception, is open from **7 a.m. to 1 a.m.**, after which it will be opened every half hour: at 1.30 - 2.00 - 2.30 a.m. etc.

The **barrier to the campsite**, which allows vehicles access to the pitches, is situated after Reception and is open **from 7 a.m. until 2 p.m.** and **from 4 p.m. to 11 p.m.** Guests who plan to leave the Campsite using their own vehicles outside these hours have to park the vehicles in the allotted spaces in front of the barrier (marked with the “P” sign).

MOTOR VEHICLES - PEACE AND QUIET

All motor vehicles and motorbikes can not circulate during the **two quiet periods: from 2 p.m. to 4 p.m.** and **from 11 p.m. to 7 a.m.**

The **speed** may not exceed **20 km** per hour.

During hours not covered by the designated quiet periods, radios, television sets and musical instruments are tolerated as long as they are set to low volume and do not disturb the other camping guests nearby.

RATES - DEPARTURE – PAYMENT AND GUESTS

The rates shown on our price-list include the free access to the Wifi network, and refer to an **overnight stay ending at 10 a.m.** of the following day. Staying on the pitch after 10 a.m. is therefore subject to payment.

Any change in the number of persons or vehicles must be communicated to Reception the same day that the change occurs.

Camper who intend to receive guests must inform Reception. The guests must be registered as visiting the host and can stay within the Campsite **from 9:00 a.m. to 10:00 p.m.** If guests stay overnight then they will be subject to the registration procedure for Campers, and the rate will be charged to the hosting Camper.

TELEPHONE – INTERNET POINT - TOBACCO - POSTCARDS

Telephones, fax, internet and photocopy machines are available in our Telephone Office, where guests may also buy cigarettes and postcards.

During **July and August** the office is open **from 8 a.m. to 11p.m.** while in the other months opening times are shorter.

Free Wi-Fi Internet access is available in every part of the Campsite.

SWIMMING-POOLS

The three swimming pools at “Parco delle Piscine” are fed by running thermal water at a constant temperature of approximately 24 °C.

The **large swimming pool with a waterfall**, situated in the park, is open **from 3 April to 30 September: until 8 May** it is open **from 8 a.m. to 1 p.m.** and **from 2 p.m. to 6 p.m.**, while **from 9 May to 30 September** it is open continuously **from 9 a.m. to 7 p.m.**

The **children’s swimming pool** will be opened **during the month of May** and will remain open **until the end of August, from 9 a.m. to 7 p.m.**

The **third swimming pool, located in the campsite** is only available to our campers. It is open **from the beginning of July until the end of August** with the following hours: **from 8 a.m. to 1.30 p.m.** and **from 4 p.m. to 8 p.m.**

SERVICES INCLUDED IN THE PRICE LIST

- WI-FI Internet access over the entire area
- Hedge-screened pitches of at least 110 m², or a pitch in an open space
- Mobile-homes in hedge-screened pitches of at least 120 m², and all furnished and fully equipped for comfort - bedding and towels excluded
- Use of the three swimming pools with solarium, lawn chairs and umbrellas
- Use of the sanitary facilities, showers, hot and cold water
- Use of the sport facilities: table tennis, volley-and basketball
- Use of the large playground for children
- Use of the vita gym equipment
- Use of the vast and equipped park grounds for games and picnics
- Entertainments for children and adults in high season (July and August)
- Live music at the bar in high season
- Gymnastics, aerobics, aqua-gym and stretching courses may be organized in high season (July and August)
- Access to the big TV room (Home Theatre and large screen, with satellite connection)
- Delivery of messages and letters to reception or to the pitches
- Custody in safe of money and small valuables
- Excursions (historical, cultural or wine and food) in July and August
- Rollerblade running track of 350 mt. (at 300 mt distance from the camping)
- Daily waste collection in the recycling centres

EXTRA SERVICES NOT INCLUDED IN THE PRICE LIST

- Internet point, telephones, fax and copy machines at the telephone office
- Hydro-massage fed by thermal water at approximately 24 °C (€ 1 to € 2 per minute)
- Use of washing machines (tokens available at Reception)
- Set-up and dismantling of verandas
- Transport of caravans from the deposit to the pitch and vice versa
- Rental of pillow cases, sheets and towels at Reception.
- Rental of baby equipment: cot, pushchair and bath with changing mat (€ 1,50 per day per piece), at Reception.
- Tennis court (€ 14 per hour during the day and € 20 per hour with night-illumination)
- Football field (€ 50 per hour during the day and € 65 with night-lighting).
Reservations at the Telephone office.
- Cooking lessons during the working days of July and August
- Painting lessons in case scheduled in July and August

INFORMATION ON ENVIRONMENTAL MANAGEMENT

The campsite obtained the EMAS certification (registration n. I-000275), as a result of the application of an Environmental Management System compliant to the European law 1221/2009.

IN THE EVENT OF FIRE

The entire campsite is well-equipped with a water-based fixed fire-prevention system. Fire-hoses are located on red columns throughout the park. There are also numerous extinguishers available, indicated on the map of the camp-site displayed on notice-boards throughout the site.

Rules to remember **in the event of emergency**:

- All vehicles should either be driven to their designated parking spaces as indicated on the maps, or if moving, must immediately park at the side of the road.
- Obey instructions from the staff, given over the loudspeakers.

RESPONSIBILITY

Bagno Santo S.p.A., the owners of the Campsite, are expressly exonerated from any direct or indirect responsibility for any harm (none excluded) which may befall a guest, whether it be the disappearance or loss of property and personal effects; illnesses; injury and / or accidents occurring in any building and / or any part of the areas serving the campsite and / or the park and / or while using any equipment and / or services.

The management is at the disposal of the campers to whom they wish a pleasant stay.

BOOKING FORM AND DEPOSIT PAYMENT

(BY FAX)

• Booking form

(To be completed and sent by fax to 0039 0578 265889)

Name _____ Surname _____

Address _____

Town/City _____ Country _____

Telephone _____ Fax _____

E-mail _____

Period requested:

Arrival (dd/mm/yy) _____ departure (dd/mm/yy) _____

No. _____ adults and no. _____ children

No. _____ Pitches

No. _____ type A) mobile homes over 40 m² (2 bedrooms, 1 bathroom) open and covered veranda included

No. _____ type B) mobile homes over 55 m² (2 bedrooms, 2 bathrooms) open veranda with covered balcony included.

• Payment of the deposit

In payment of the deposit of € 200.00 for pitch or € 400.00 for mobile home:

I enclose a copy of payment on C/C of Bagno Santo, Sarteano at the Banca Sella – Via Gonzaga 3 – 20123 Milano (Account nr. 052850877960, IBAN IT03N0326801603052850877960, SWIFT-Code SELBIT2B)

I authorize payment with the following credit card:



Expiration date: []/[] / []/[]

Name appearing on Credit Card _____

Signature _____

• How to cancel your booking

To cancel your booking you must send a written communication by mail, fax or e-mail at least 4 weeks before your scheduled arrival date. 50% of the deposit will be refunded. After this deadline you will not be entitled to any refund.

PRICE LIST FOR PITCHES

(Euro per Day)

3 April – 30 September 2015

	03.04 - 31.05	01.06 - 15.07	16.07 - 20.08	21.08 - 13.09	14.09 - 30.09
CARAVAN/TENT (with free Wifi access)	9,00	11,00	15,00	11,00	9,00
MOTORCARAVAN (with free Wifi access)	12,00	14,00	22,00	14,00	12,00
ADULTS	10,00	14,00	18,00	14,00	10,00
CHILDREN (FROM 3 TO 12 YEARS)	9,00	11,00	14,00	11,00	9,00
ADDITIONAL PRICE FOR PITCHES FROM 101 TO 199*	8,00	8,00	8,00	8,00	8,00
CAR	3,00	5,00	8,00	5,00	3,00
MOTORCYCLE	2,00	3,00	6,00	3,00	2,00
ELECTRICITY	6,00	6,00	6,00	6,00	6,00
GARAGING	2,50	2,50	2,50	2,50	2,50
LOCAL TOURIST TAX (from 13 years old)	0,80	0,80	0,80	0,80	0,80

SPECIAL OFFER FOR THE SEASON 2015 (7=6, 14=12, 21=18)

In the period from 03.04 to 15.07, for 7 consecutive days you get one night for free (7=6), for 14 consecutive days you get 2 nights for free (14=12) and for 21 consecutive days you get 3 nights for free (21=18).

* Pitches with drinking water and sewage waste disposal

RENTAL MOBILE HOMES WITH VERANDA

Type A): small + covered veranda: over 40 m², 2 Bedrooms, 1 Bathroom

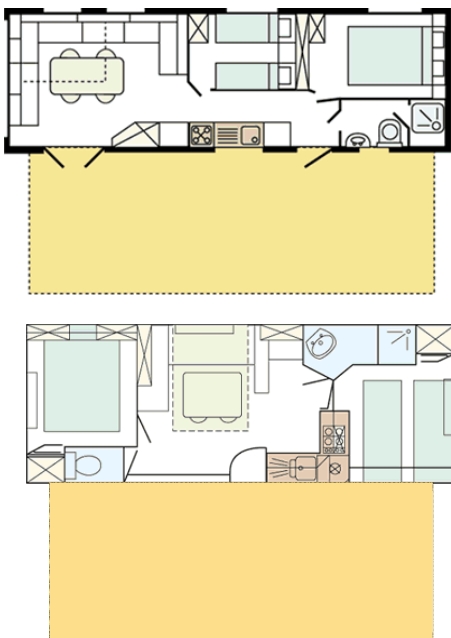

Type B): big + veranda with covered balcony: over 55 m², 2 Bedrooms, 2 Bathrooms

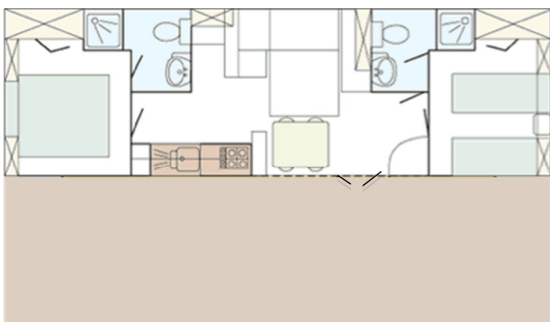

PRICE LIST FOR MOBILE HOMES

(Euro per day)

3 April - 30 September 2015

	03.04 - 31.05	01.06 - 15.07	16.07 - 20.08	21.08 - 13.09	14.09 - 30.09
TYPE A) (with free Wifi access)	55,00	85,00	130,00	85,00	55,00
TYPE B) (with free Wifi access)	70,00	110,00	165,00	110,00	70,00
ADULTS	10,00	14,00	18,00	14,00	10,00
CHILDREN (3 - 12 YEARS)	9,00	11,00	14,00	11,00	9,00
CAR	3,00	5,00	8,00	5,00	3,00
MOTORCYCLE	2,00	3,00	6,00	3,00	2,00
LOCAL TOURIST TAX (from 13 years old)	0,80	0,80	0,80	0,80	0,80

ADDITIONAL COST FOR STAYING ONLY ONE OR TWO DAYS:

- 1 day 25.00
- 2 days 12.50 each day

SPECIAL OFFER FOR THE SEASON 2015 (7=6, 14=12, 21=18)

In the period from 03.04 to 15.07, for 7 consecutive days you get one night for free (7=6), for 14 consecutive days you get 2 nights for free (14=12) and for 21 consecutive days you get 3 nights for free (21=18).

Mobile homes are an ideal choice for families looking for a relaxing holiday in a natural setting. Designed to meet the highest technical specifications they have a great deal of both indoor and covered and equipped outdoor space (ca. 21 sqm). As well as an ample patio, the mobile homes are equipped with everything you need for day-to-day living - hot and cold running water, one or two bathrooms, shower, washbasin, toilet, hob, fridge, cutlery, tableware kitchenware and in the patio lawn chairs and barbecue.

IMPORTANT:

- Price includes the use of gas and electricity, hot water and the fridge.
- Our mobile homes are not equipped with pillow cases, sheets, and towels. These as well as baby equipment (cot, pushchair, bath and changing table) can be rented at Reception.
- Each mobile home is equipped with a laundry rack. This must be used for hanging out all washing. It is not allowed to hang washing anywhere else.